

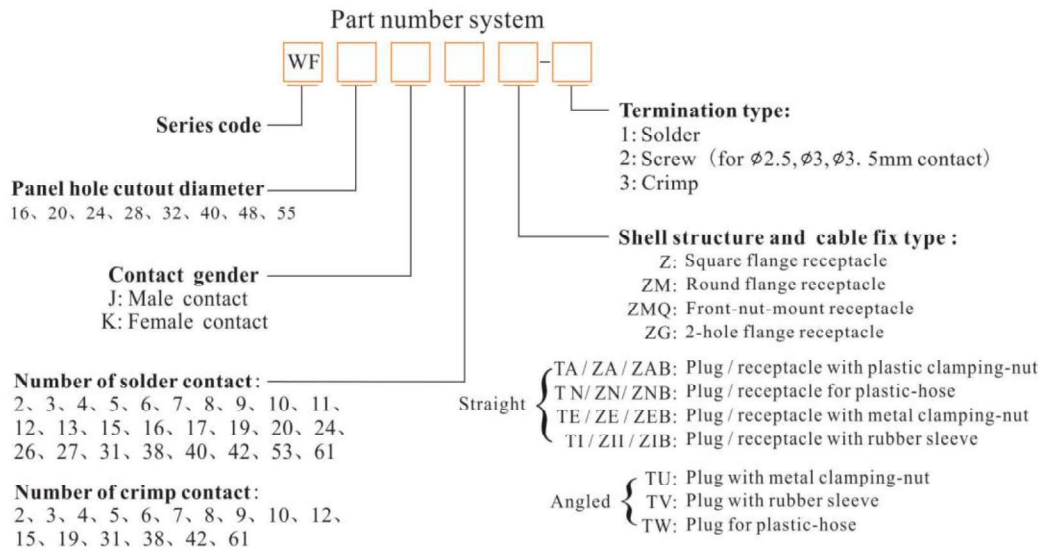

● **WF Series**



● **Remarks :** The rated current decreases according to the number of contacts, more contacts, less rated current.

Number of contact	1-3	4-10	11-20	21-30	31-40	41-50	51-61
Rated current decrease rate (%)	0	10	20	30	40	50	60

- ★ Each side can be male or female contact
- ★ Solder contact spec see page 87-88
- ★ Crimp contact spec see page 89-92

Material and spec

Coupling	Threaded
Shell material	Zinc alloy with chrome plating
Insert material	PPS, max temperature 260 °C
Contact material	Brass with gold plating
Termination	Solder: $\phi 1, 1.5, 2.5, 3.5, 5, 5$ mm contact Screw: $\phi 2.5, 3, 3.5$ mm contact Crimp: $\phi 1, 1.5, 2.5, 3.5$ mm contact
Mating cycle	500
Temperature range	-40°C~+85°C

WF Series Mating diagram

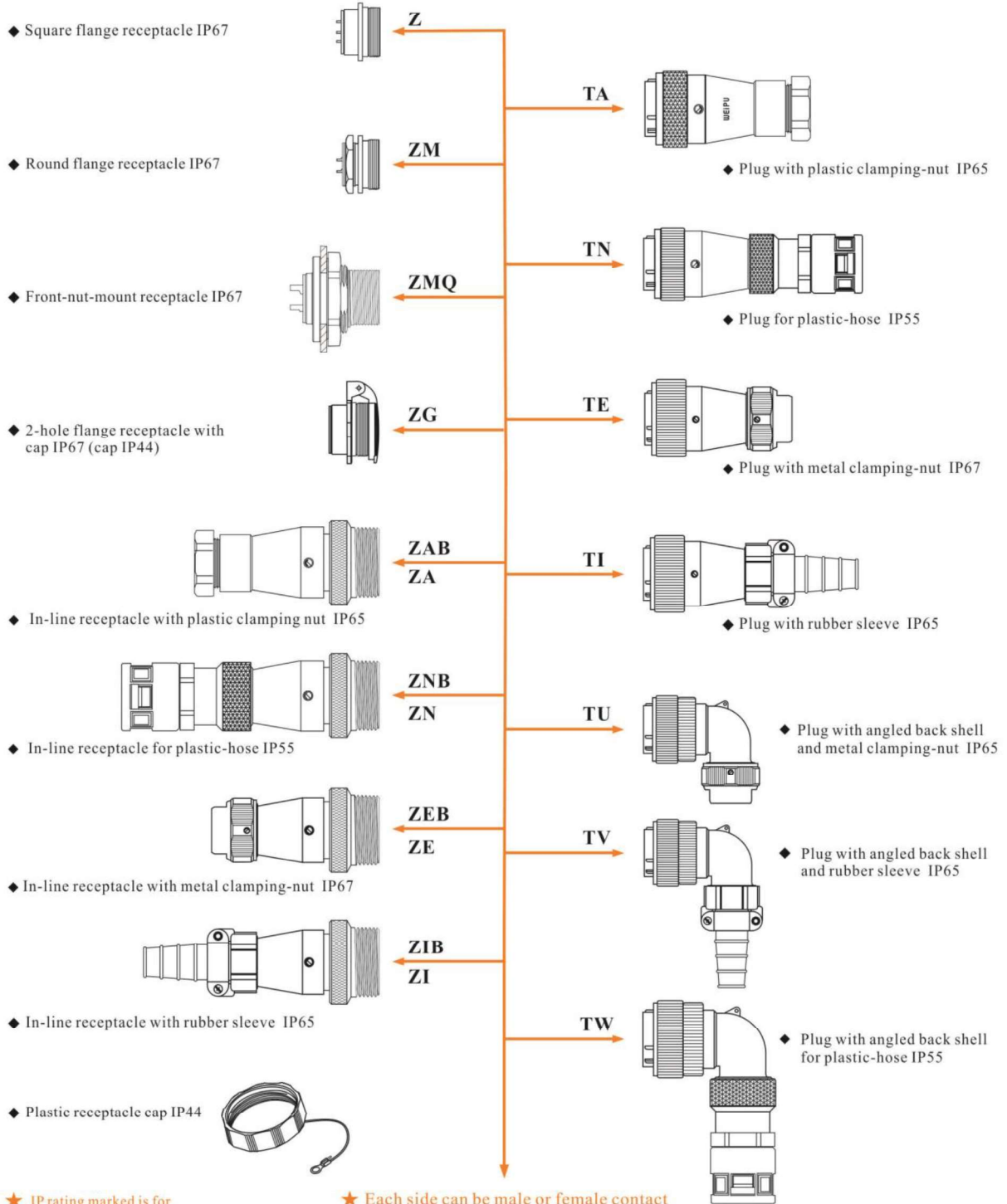

★ IP rating marked is for after mated or with cap.

★ Each side can be male or female contact

★ Solder contact spec see page 87-88

★ Crimp contact spec see page 89-92



● Square flange receptacle: Z IP67

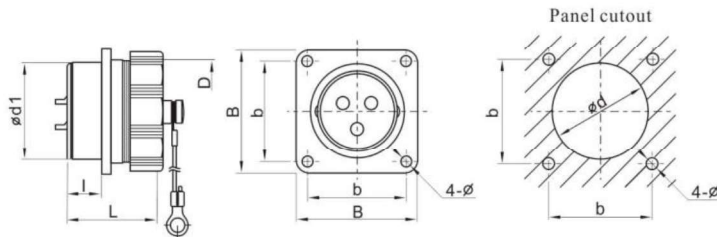

Dimension(mm)	WF16	WF20	WF24	WF28	WF32	WF40	WF48	WF55
$\phi d1$	15.8	19.8	23.8	27.8	31.8	39.8	47.8	54.8
D	M18X1	M22X1	M26X1	M30X1	M35X1	M44X1	M52X1.5	M59X1.5
I	9.7	9.8	10	9.8	14.4	14.2	14.2	14
L	21.6	23	23	23	34	34	34	34
b	20	22	26	30	32	40	48	52
B	26	29	32	36	42	50	58	64
ϕd	16.5	20.5	24.5	28.5	32.5	40.5	48.5	55.5
ϕ	3.2	3.2	3.2	3.2	3.5	4.5	4.5	4.5

● Round flange receptacle: ZM IP67

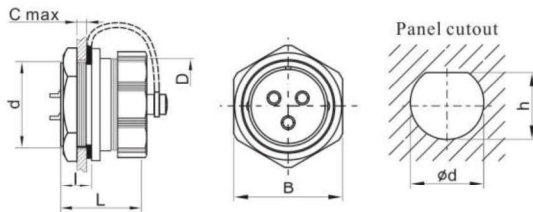

Dimension(mm)	WF16	WF20	WF24	WF28
d	M16X1	M20X1	M24X1	M28X1
D	M18X1	M22X1	M26X1	M30X1
C	5	5	5	5
I	9.7	9.9	10	10.2
L	22	23	23	23
B	21.2	25.5	29.2	33.3
ϕd	15.7	19.7	23.9	27.7
h	15.3	19.3	23.2	26.9



● Front-nut-mount panel receptacle: ZMQ IP67

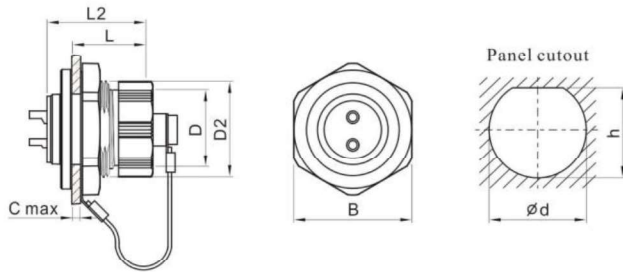

Dimension(mm)	WF16	WF20	WF24	WF28
D	M18X1	M22X1	M26X1	M30X1
D2	M22X1	M26X1	M30X1	M34X1
L	16	17	17	17
L2	21.6	23	23	23
C	5	5	5	5
B	26.8	30.8	34.8	38.8
ød	22	26	30	34
h	20.6	24.6	28.6	32.6

● 2-hole flange receptacle with cap: ZG IP67(cap IP44)

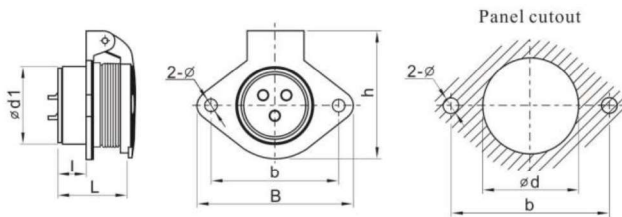

Dimension(mm)	WF16	WF20	WF24	WF28	WF32	WF40	WF48	WF55
ød1	15.8	19.8	23.8	27.8	31.8	39.8	47.8	54.8
l	10	10	10	10	15.4	14.7	14.3	14
L	22	23	23	23	34	34	34	34
b	30	35	40	45	55	65	80	85
B	38	44	50	55	67	77	92	98
h	32.5	36.5	40.5	45.5	52.5	63.5	74.5	80
ød	16.5	20.5	24.5	28.5	32.5	40.5	48.5	55.5
ø	3.5	4.5	4.5	4.5	5.5	5.5	5.5	6.5



● In-line receptacle with plastic clamping-nut B: ZAB IP65

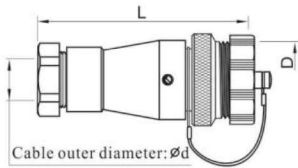

Dimension(mm)	WF16	WF20	WF24	WF28
D	M18X1	M22X1	M26X1	M30X1
L	53	65	68	74.5
$\varnothing d$	4.5-7	5-12	5-12	6.5-15.5

● In-line receptacle with plastic clamping-nut: ZA IP65

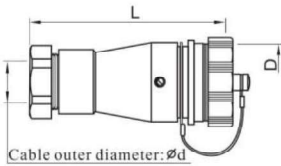

Dimension(mm)	WF32	WF40	WF48	WF55
D	M35X1.5	M44X1.5	M52X1.5	M59X1.5
L	92	109	116	110
$\varnothing d$	8.5-19.5	11.5-24.5	11.5-24.5	15-31

● Plug with plastic clamping-nut: TA IP65

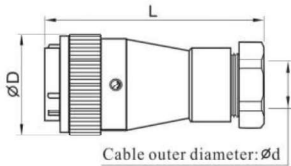

Dimension(mm)	WF16	WF20	WF24	WF28	WF32	WF40	WF48	WF55
$\varnothing D$	21	25.6	30	34.2	38.2	46.2	55.8	63
L	54	65	68	73	90	101	102	107
$\varnothing d$	4.5-7	5-12	5-12	6.5-15.5	8.5-19.5	11.5-24.5	11.5-24.5	15-31

● In-line receptacle with metal clamping-nut B: ZEB IP67

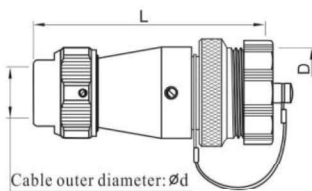

Dimension(mm)	WF16	WF20	WF24	WF28
D	M18X1	M22X1	M26X1	M30X1
L	55	63	66.5	70
$\varnothing d$	5-6.5	9-10.5	9-10.5	10.5-12.5

● In-line receptacle with metal clamping-nut: ZE IP67

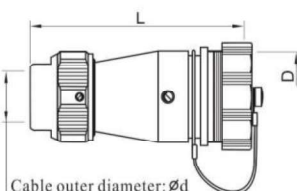

Dimension(mm)	WF32	WF40	WF48	WF55
D	M35X1.5	M44X1.5	M52X1.5	M59X1.5
L	90.4	103.6	108	131.6
$\varnothing d$	15.5-17	18-20	I: 18-20 II: 24.5-26	24.5-26



● Plug with metal clamping-nut: TE IP67

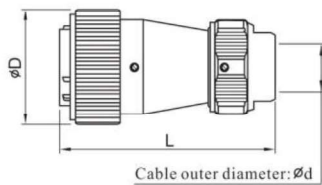

尺寸 Dimension(mm)	WF16	WF20	WF24	WF28	WF32	WF40	WF48	WF55
øD	21.8	26.4	29.8	34	39.3	49.3	57.2	64.5
L	52.6	61.3	67.3	67.4	88	102.9	107.7	131.6
ød	5-6.5	9-10.5	9-10.5	10.5-12.5	15.5-17	18-20	I: 18-20 II: 24.5-26	24.5-26

● Plug with angled back shell and metal clamping-nut: TU IP65

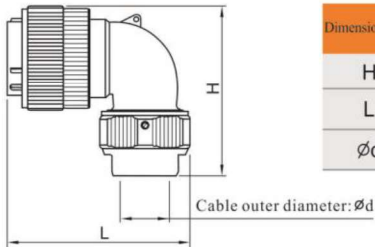

Dimension(mm)	WF16	WF20	WF24	WF28	WF32	WF40	WF48	WF55
H	43.2	50.3	54	56.7	74.6	80	98	105.2
L	47.5	55	58.3	72	82.5	91.5	98.5	109.2
ød	5-6.5	9-10.5	9-10.5	10.5-12.5	15.5-17	18-20	24.5-26	24.5-26

● In-line receptacle with cable clamping plates B: ZIB IP65

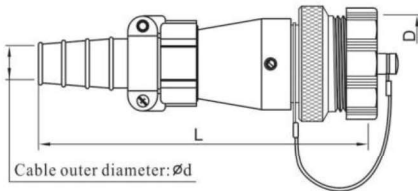

Dimension(mm)	WF16	WF20	WF24	WF28
D	M18X1	M22X1	M26X1	M30X1
L	73.5	90	93.5	104
ød	7-8	8-10.5	8-10.5	11.5-13.6

● In-line receptacle with cable clamping plates: ZI IP65

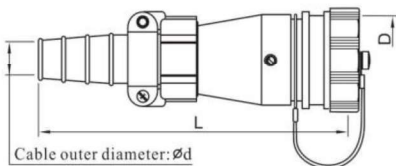

Dimension(mm)	WF32	WF40	WF48	WF55
D	M35X1.5	M44X1.5	M52X1.5	M59X1.5
L	118.6	130.2	137	210.5
ød	13-15.6	15.5-18.8	I: 15.5-18.8 II: 24-28	24-28



● Plug with rubber sleeve: TI IP65

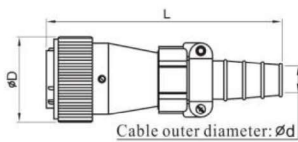

Dimension (mm)	WF16	WF20	WF24	WF28	WF32	WF40	WF48	WF55
øD	21.5	26.4	29.8	34	39.3	49.3	57.2	64.5
L	72.3	86.9	92.5	100.6	118.3	130.4	137.2	161.1
ød	7-8	8-10.5	8-10.5	11.5-13.6	13-15.6	15.5-18.8	I:15.5-18.8 II:24-28	24-28

● Plug with angled back shell and rubber sleeve: TV IP65

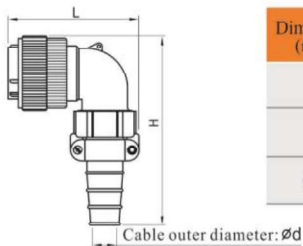

Dimension (mm)	WF16	WF20	WF24	WF28	WF32	WF40	WF48	WF55
H	60	80	80	93	107	118	127	140
L	45.5	53	56.3	70	80.5	89.5	98	107.2
ød	7-8	8-10.5	8-10.5	11.5-13.6	13-15.6	15.5-18.8	24-28	24-28

● In-line receptacle for plastic-hose: ZNB IP55

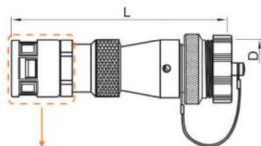

Optional plastic hose adapter

Dimension (mm)	WF16	WF20	WF24	WF28
D	M18X1	M22X1	M26X1	M30X1
L	80	90	97	104
Adapter size	PG7	PG11	PG11	PG16
Hose size	1/4"	3/8"	3/8"	1/2"

● In-line receptacle for plastic-hose: ZN IP55

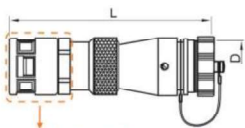

Optional plastic hose adapter

Dimension (mm)	WF32	WF40	WF48	WF55
D	M35X1.5	M44X1.5	M52X1.5	M59X1.5
L	126.7	134	141	160
Adapter size	PG21	PG29	I: PG29 II: PG36	PG36
Hose size	3/4"	1"	I: 1" II: 1 1/4"	1 1/4"



● Plug for plastic-hose: TN IP55

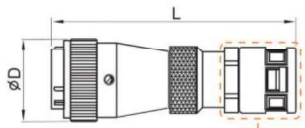

Optional plastic hose adapter

Dimension (mm)	WF16	WF20	WF24	WF28	WF32	WF40	WF48	WF55
øD	21.5	26.8	29.8	34	39.3	49.3	57.2	64.5
L	63	75	60	63	120	132	138	150
Adapter size	PG7	PG11	PG11	PG16	PG21	PG29	I: PG29 II: PG36	PG36
Hose size	1/4"	3/8"	3/8"	1/2"	3/4"	1"	I: 1" II: 1 1/4"	1 1/4"

● Plug with angled back shell for plastic-hose: TW IP55

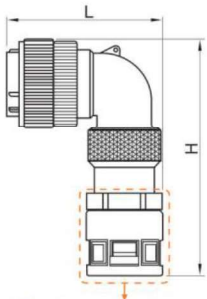

Optional plastic hose adapter

Dimension (mm)	WF16	WF20	WF24	WF28	WF32	WF40	WF48	WF55
H	58	78	78	91	105	120	125	132
L	46.5	54	57.3	71	81.5	90.5	98	108
Adapter size	PG7	PG11	PG11	PG16	PG21	PG29	PG29	PG36
Hose size	1/4"	3/8"	3/8"	1/2"	3/4"	1"	1 1/4"	1 1/4"